

MEK-SIS PROJESİ KAPSAMINDA

EGE ÜNİVERSİTESİ BİNALARININ MİMARİ TASLAK KAT PLANLARININ HAZIRLANMASI İŞİ

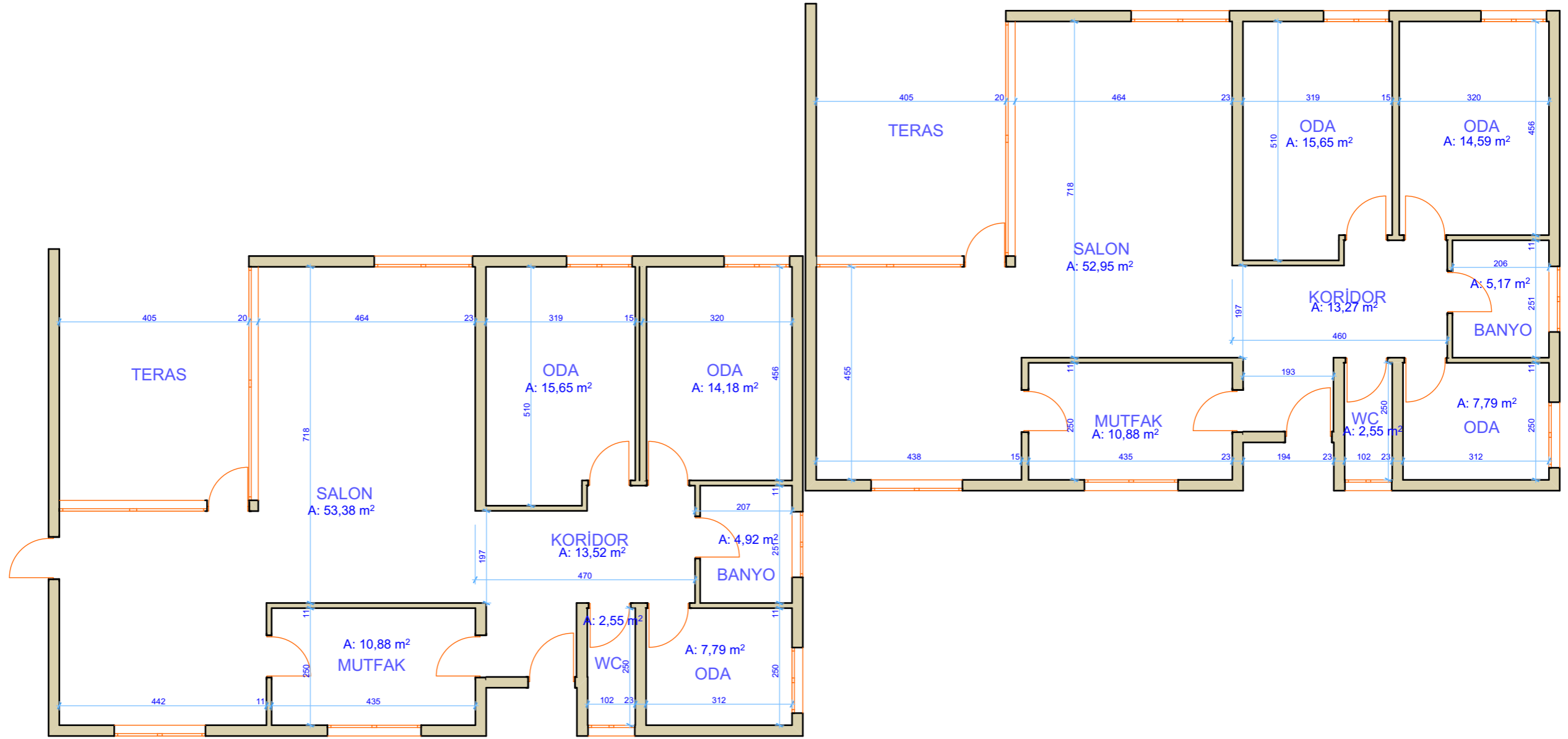

İKN
2018/295315

EÜ LOJMANLAR
A3-A4 BLOK ZEMİN KAT PLANI

ALAN : 338,58 m² x 2 = 677,16 m²

