

MEK-SIS PROJESİ KAPSAMINDA

EGE ÜNİVERSİTESİ BİNALARININ MİMARİ TASLAK KAT PLANLARININ HAZIRLANMASI İŞİ

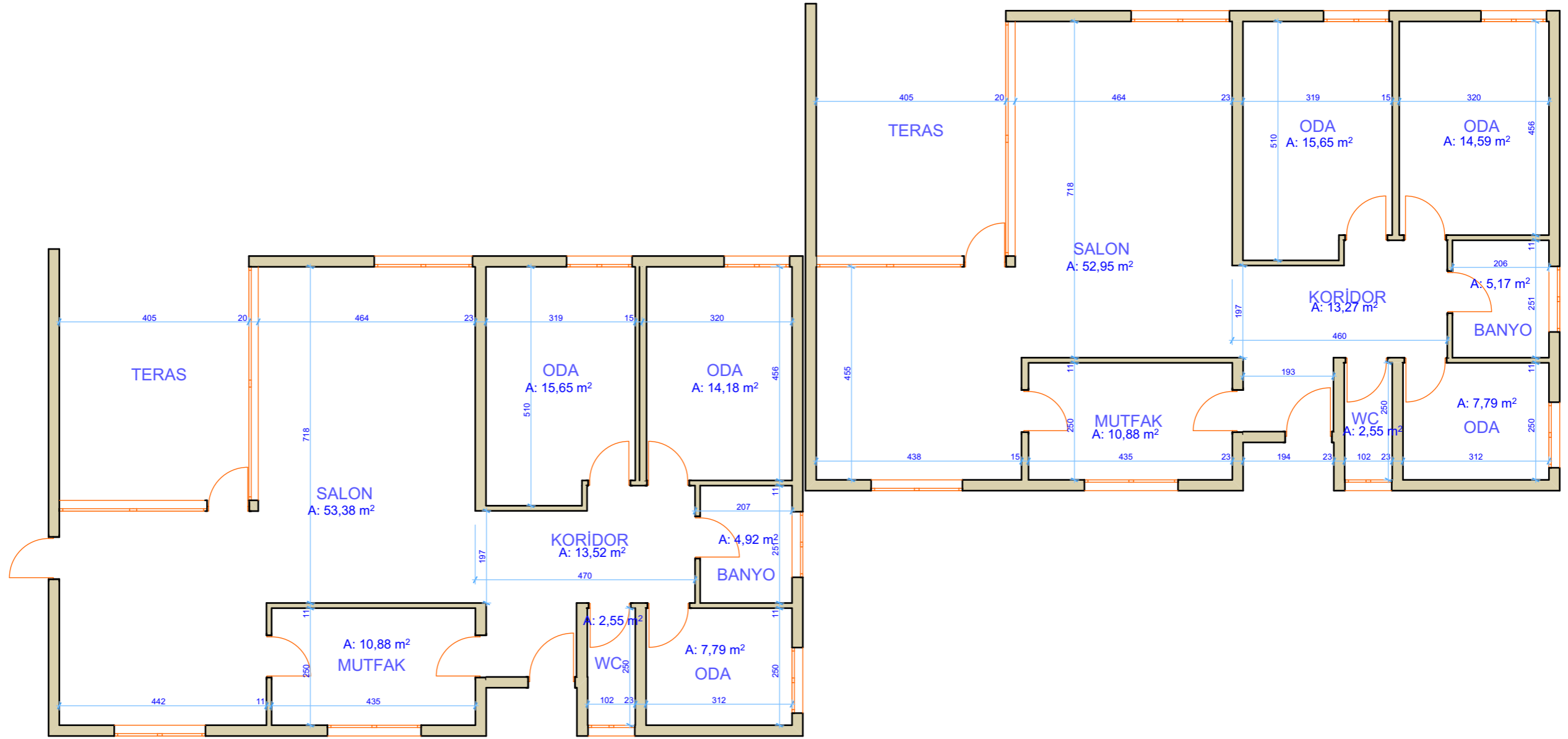

İKN  
2018/295315

**EÜ LOJMANLAR**  
**A5-A6 BLOK ZEMİN KAT PLANI**

**ALAN : 338,58 m<sup>2</sup> x 2 = 677,16 m<sup>2</sup>**

